



LOCATION A WITHOUT POLE



LOCATION A WITH POLE



LOCATION B WITHOUT POLE



LOCATION B WITH POLE

DESCRIPTION:

A 5.5-metre high, 89dia pole at the rear of the foot-path immediately in front of the 2 Manchester Drive east flank concrete end fence post with a wire crossing Manchester Drive to a matching pole adjacent to the school playing fields railing directly behind the telegraph pole opposite, slightly to the west.

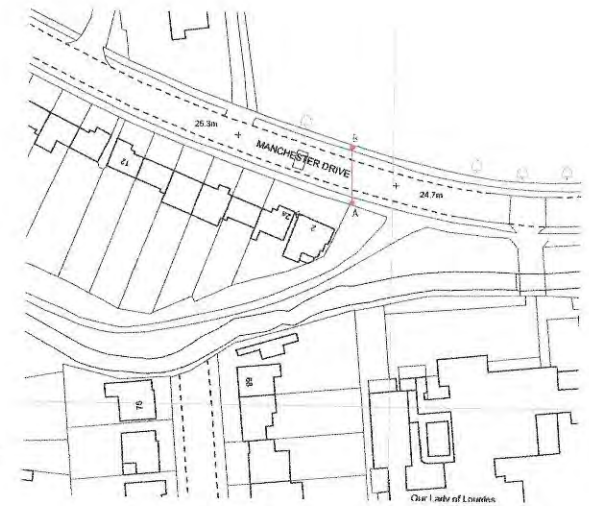

LOCATION PLAN SCALE 1:1250

WESTCLIFF ERUV - LOCATION 16 - MANCHESTER DRIVE

Rev'n A

DRAWING REF: 911.16

ROSENFELDER ASSOCIATES
 Chartered Architects + Planning Consultants
 10-12 Perrins Court Hampstead LONDON NW3 (020) 7794 4425